

Active Speaker System

Operating Instructions
Mode d'emploi
Manual de instrucciones

SRS-T88

http://www.sony.net/

© 2004 Sony Corporation

Printed in Philippines

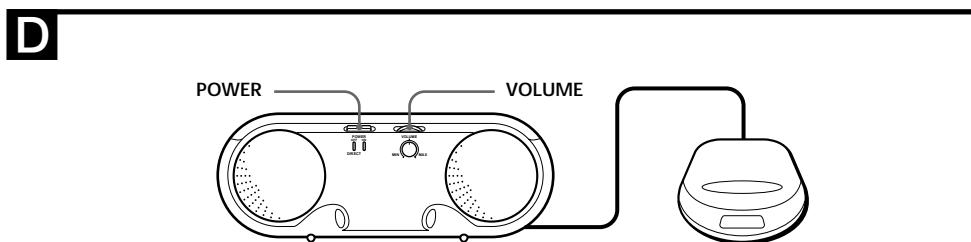
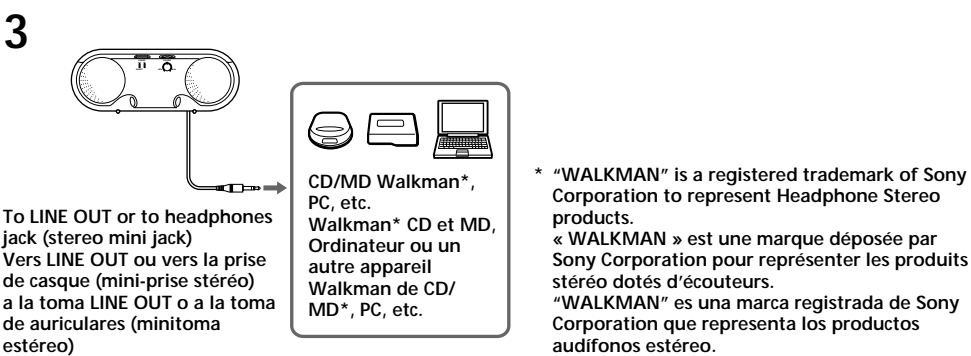
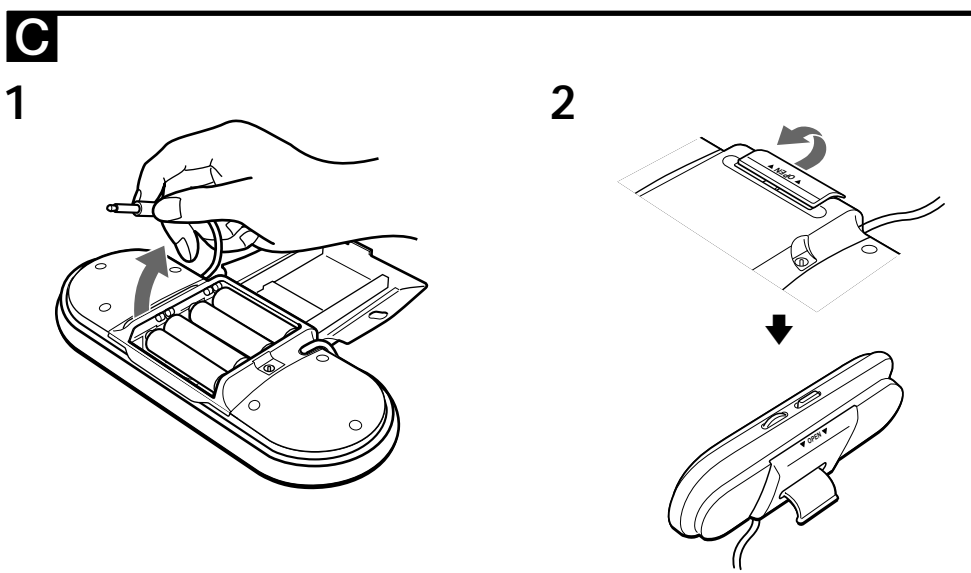
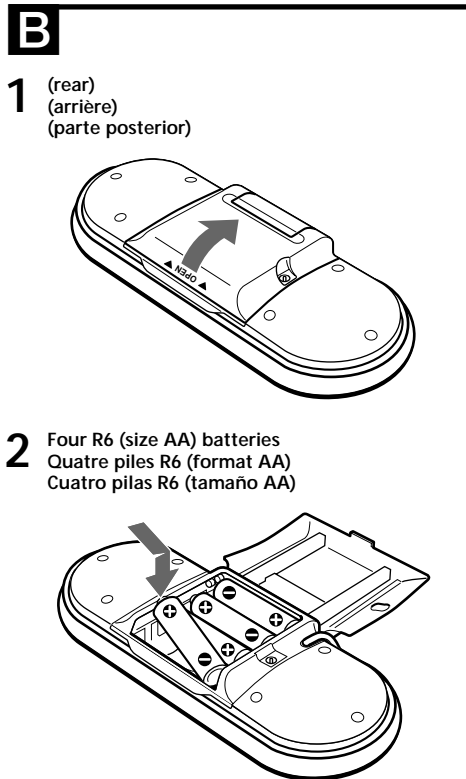
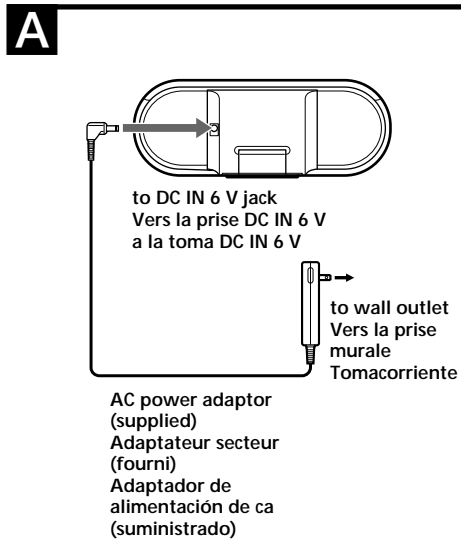

English

Before operating the unit, please read this manual thoroughly and retain it for future reference.

WARNING

To prevent fire or shock hazard, do not expose the unit to rain or moisture.
To avoid electrical shock, do not open the cabinet. Refer servicing to qualified personnel only.
To prevent fire, do not cover the ventilation of the apparatus with news papers, table-cloths, curtains, etc. Do not place lighted candles on the apparatus.
To prevent fire or shock hazard, do not place objects filled with liquids, such as vases, on the apparatus.

Do not install the appliance in a confined space, such as a bookcase or built-in cabinet.

CAUTION

You are cautioned that any changes or modification not expressly approved in this manual could void your authority to operate this equipment.

For the customers in the U.S.A.

This device complies with Part 15 of the FCC rules. Operation is subject to the following two conditions: (1) this device may not cause harmful interference, and (2) this device must accept any interference received, including interference that may cause undesired operation.

The validity of the CE marking is restricted to only those countries where it is legally enforced, mainly in the countries EEA (European Economic Area).

Precautions

On safety

The nameplate indicating operating voltage, power consumption, etc., is located on the rear exterior.
• Before operating the system, be sure that the operating voltage of the system is identical with that of your local power supply.

Where purchased	Operating voltage
U.S.A./Canada	120 V AC, 60 Hz
European countries	220 - 230 V AC, 50 Hz
Other countries	• 110 - 120 V AC, 50/60 Hz • 220 - 230 V AC, 50 Hz

- Use only the supplied AC power adaptor.
- After operating the system with the AC power adaptor, disconnect the AC power adaptor from the wall outlet if the system is not to be used for an extended period of time. The POWER switch does not turn the AC power adaptor off.

On operation

- Do not open the cabinet. Refer servicing to qualified personnel only.
- Should any solid object or liquid fall into the system, have the system checked by qualified personnel before operating it any further.
- Although this system is magnetically shielded, do not leave recorded tapes, watches, personal credit cards, or floppy disks with magnetic coding in front of the system for an extended period of time.

If the TV picture or monitor display is magnetically distorted

Although this system is magnetically shielded, there may be cases that the picture on some TV sets/personal computer sets may become magnetically distorted. In such a case, turn off the power of the TV set/personal computer set once, and after 15 to 30 minutes turn it on again. For the personal computer set, take the appropriate measures such as data storage before turning it off.
When there seems to be no improvement, locate the system further away from the TV set/personal computer set. Furthermore, be sure not to place objects in which magnets are attached or used near the TV set/personal computer set, such as audio racks, TV stands, toys etc. These may cause magnetic distortion to the picture due to their interaction with the system.

On placement

- Do not set the speakers in an inclined position.
- Do not leave the system in a location near heat sources, or in a place subject to direct sunlight, excessive dust, moisture, rain or mechanical shock.

On cleaning

Do not use alcohol, benzine, or thinner to clean the cabinet.

If you have any questions or problems concerning your speaker system, please consult your nearest Sony dealer.

Power Sources

Using on house current

(See fig. A)

When the AC power adaptor is connected to the system, internal batteries are automatically disconnected.

Note on the AC power adaptor

Use only the supplied AC power adaptor. Do not use any other AC power adaptor to avoid damaging the speakers.



Battery installation

(See fig. B)

Battery replacement

When the batteries are weak, the playback sound will become distorted or unstable. In such a case, replace all the batteries with new ones.

Battery life	(5 mW + 5 mW output)
Battery type	Usage time
Sony alkaline battery LR6 (SG)	Approx. 30 hours*
Sony manganese battery R6	Approx. 15 hours*

* Usage time stated above may vary according to the temperature or conditions of use.

Hooking up the speakers

(See fig. C)

- 1 Open the battery compartment lid to pull out the input cord.
- 2 Set the speaker system on a flat surface.
- 3 Connect the speaker to the source equipment.

When the system is connected to the monaural jack of a radio, etc., the sound may not come through the right speaker. In such a case, use the optional* plug adaptor PC-236MS.

To connect to a stereo phone-type headphones jack

Use the optional* PC-234S plug adaptor or RK-G138 connecting cord.

* The above optional accessories are not provided in some areas.

Listening to the sound (See fig. D)

First, turn down the volume on this unit. Before connecting the speakers to the headphone output, reduce the volume of the connected component.

- 1 Set the POWER switch to ON.
The POWER ON indicator becomes green.

2 Adjust the VOLUME control.

When connecting to the headphone output, also adjust the volume of the connected component. After listening, set the POWER switch to OFF/DIRECT. The POWER OFF/DIRECT indicator becomes black.

Note

Turn off the MEGA BASS or BASS BOOST (Walkman, etc.) function as it may cause audible distortion.

To operate this unit without the built-in amplifier

Set the POWER switch to OFF/DIRECT. In such a case, the VOLUME dial on this system will not work. Adjust the volume of the connected component.

Troubleshooting

Should you have a problem with your speaker system, check the following list and take the suggested measures. If the problem persists, consult your nearest Sony dealer.

There is no sound from the speaker system.

- Make sure all the connections have been correctly made.
- Make sure the volume on this unit and the connected component have been turned up properly.
- Replace all the batteries with new ones, if batteries are used with this system.

The sound is distorted.

- Turn down the volume level on the connected component. Or, if the connected component has a bass boost function, set it to off.
- Rotate VOLUME on this unit to reduce the volume.
- Replace all the batteries with new ones, if batteries are used with this system.

There is hum or noise in the speaker output.

- Make sure all the connections have been correctly made.
- Make sure none of the audio components are positioned too close to the TV set.

The sound has suddenly stopped.

Make sure all the connections have been correctly made.

Specifications

Speaker section	
Enclosure type	Full range, Bass reflex, magnetically shielded
Speaker system	34 mm (diameter)
Impedance	8 Ω
Rated input power	2 W
Maximum input power	3 W
Amplifier section	
Rated output	2 W + 2 W (10% T.H.D., 1 kHz, 8 Ω)
Bass boost	MEGA BASS
Input	Input cord a stereo-mini plug (40 cm) × 1
Input impedance	4.7 kΩ (at 1 kHz)
General	
Power	Four R6 (size AA) batteries, DC 6 V (supplied AC power adaptor)
Dimensions (w/h/d)	approx. 198 × 75 × 36 mm (7 7/8 × 3 × 1 7/16 inch) (during use)
Mass	approx. 350 g (12 oz.) including batteries

Supplied accessories

- Carrying Pouch (1)
- AC power adaptor (1)
- Operating Instructions (1)
- Plug adaptor* (1)
- * For world wide model (Tourist model, on sale in Japan only)

Optional accessories

- Connecting cord RK-G136, RK-G138
- Plug adaptor PC-234S, PC-236MS

The above optional accessories are not provided in some areas.

Design and specifications are subject to change without notice.

